



DORSET
REALTY
GROUP

215 – 10451 Shellbridge Way, Richmond, BC V6X 2W8
Tel: (604) 270-1711 | general@dorsetrealty.com
www.dorsetrealty.com

FOR SUBLEASE

CRESTWOOD CORPORATE CENTRE

Suite 320 (300)
13711 International Place
Richmond, B.C.



For additional information on this opportunity, please contact:

Colin Schuss
Vice President Commercial Sales & Leasing
DORSET REALTY GROUP CANADA LTD.
604.270.1711 Ext 104 office
604.760.7559 cell / text
colinschuss@dorsetrealty.com

The information contained herein has been obtained from the owner or from other sources deemed reliable by Dorset Realty Group Canada Ltd. We have no reason to doubt its accuracy although are not able to guarantee it. All information herein contained is subject to change or withdrawal without notice.

Location:

Crestwood Corporate Centre is a first-class business park located in Central Richmond with close proximity to Highways 91 & 99 and YVR. On site amenities include tenant shuttle, food services, daycare, and fitness. Building 10 is well positioned at one of the main entrances to the business park from No 6 Road on retail level. See map below.

Premises:

The Premises are located at the front centre section of the second floor of Building 10.

| Suite # | Floor Area | Base Rent | Features |
|-------------------------|--------------|-----------|----------------------------------------------------------------------------------------------------------------------------------------------|
| #320 (formerly #300) | 3,215 Sq.Ft. | Enquire | Fully improved with high quality improvements, grand entrance, reception, 4 to 5 offices, 1 meeting room, 1 large display area, and kitchen. |

Operating Costs:

Estimated at \$13.55 Per Square Foot Per Annum (Year 2020/2021) includes utilities and janitorial. Enquire as to current estimate, subject to change.

Availability:

Within 30 days

SubLease Term:

To July 30th, 2023

Parking:

3 stalls for every 1,000 sq ft leased.

**For Sublease - #320 – 13711 International Place
Located in Building 10**



SUITE FLOOR PLAN

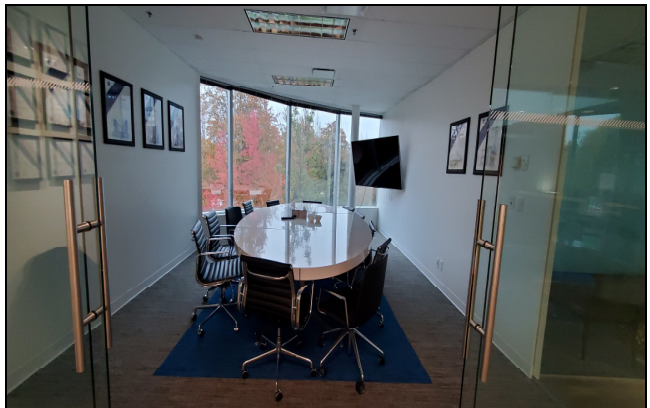
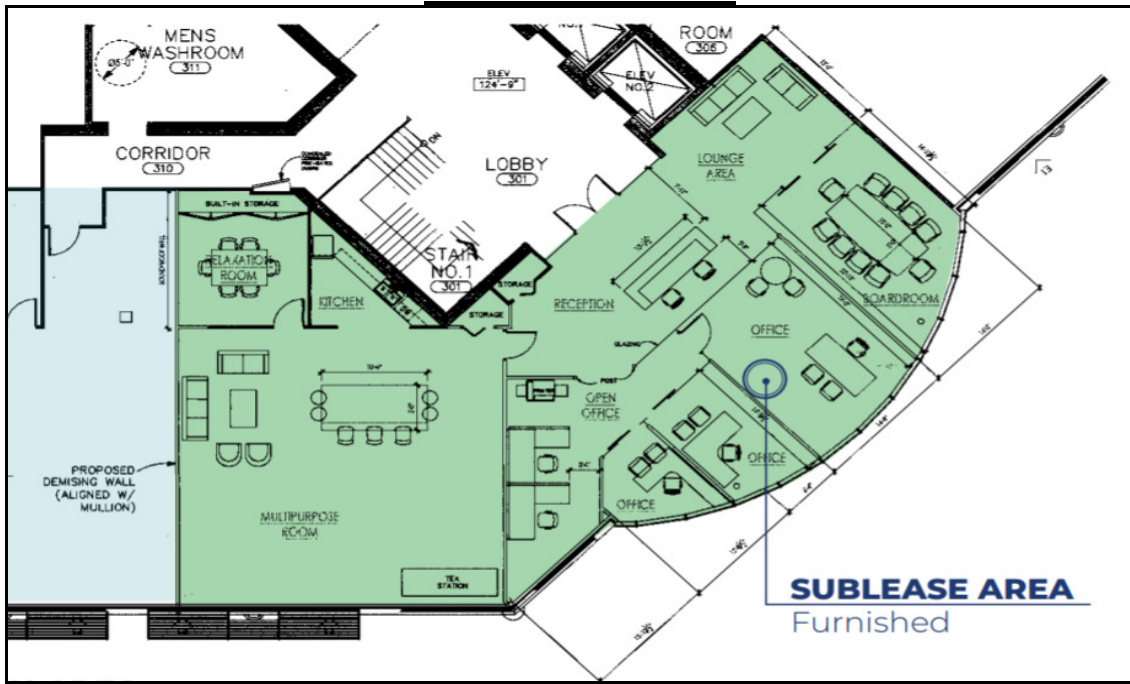

**DORSET
REALTY**
GROUP

215 – 10451 Shellbridge Way, Richmond, BC V6X 2W8
Tel: (604) 270-1711 | general@dorsetrealty.com
www.dorsetrealty.com

The information contained herein has been obtained from the owner or from other sources deemed reliable by Dorset Realty Group Canada Ltd. We have no reason to doubt its accuracy although are not able to guarantee it. All information herein contained is subject to change or withdrawal without notice